



Otter Pro Ice Lodge Installation and Set-Up Instructions

Otter Pro Ice Lodge Fits Magnum Otter II & Pro Sled Only Parts Identification and Check List

MODEL NUMBERS:

House Only Thermal Ice Camo 2446

Complete Pkg Thermal Ice Camo 2846

***Note: House Only does not include parts indicated below. Also, disregard pages 2, 3, and 4 of this instruction.**

PARTS LIST

Item #	Qty	Part #	Description
1	1	1140	Sled - Black (Sold Separately)
2	1	90369	Tent-Ice Camo Lodge
3	1	80172	Frame Bracket "A"
4	1	80171	Frame Bracket "B"
5	1	80517	Back Wind Support Bar - 49 1/2"
6	1	80518	Center Wind Support Bar - 34 5/8"
7	1	80519	Center Wind Support Bar - 44 3/4"
8	1	80512	Adjustable Front Wind Support Bar
9	2	80470	Main Frame Extension Bar - 31 1/2"
10	2	80471	Main Frame Extension Bar - 32 1/2"
11	4	80472	Main Frame Extension Bar - 30"
12	2	80474	Outer Main Frame Bar - 33"
13	6	80473	Outer Main Frame Bar - 29 9/16"
14	4	80475	Middle Main Frame Bar - 52"
*15	2	90021	Seat
*16	2	95368	Seat Bracket
*17	2	95348	Seat Base
*18	1	90354	Seat Rail - 67"
*19	2	80492	Seat Rail Cap
*20	2	95369	Seat Rail Bracket
21	8	80489	Sleeve
22	16	40714	Self Tapping Screw & Plastic Protector
	12	40714	Self Tapping Screw
23	8	80487	Black Plug
24	8	80488	Black End Cap
25	4	40103	5/16 Washer
	*10	40103	5/16 Washer
*26	8	40024	1/4 x 1/2 Hex Bolt
*27	6	40598	1/4 x 3/4 Hex Bolt
28	12	80013	1/4 Nylon Hex Lock Nut
	*18	80013	1/4 Nylon Hex Lock Nut
29	*2		5/16 x 2 Hex Bolt
30	*2		5/16 Nylon Hex Lock Nut

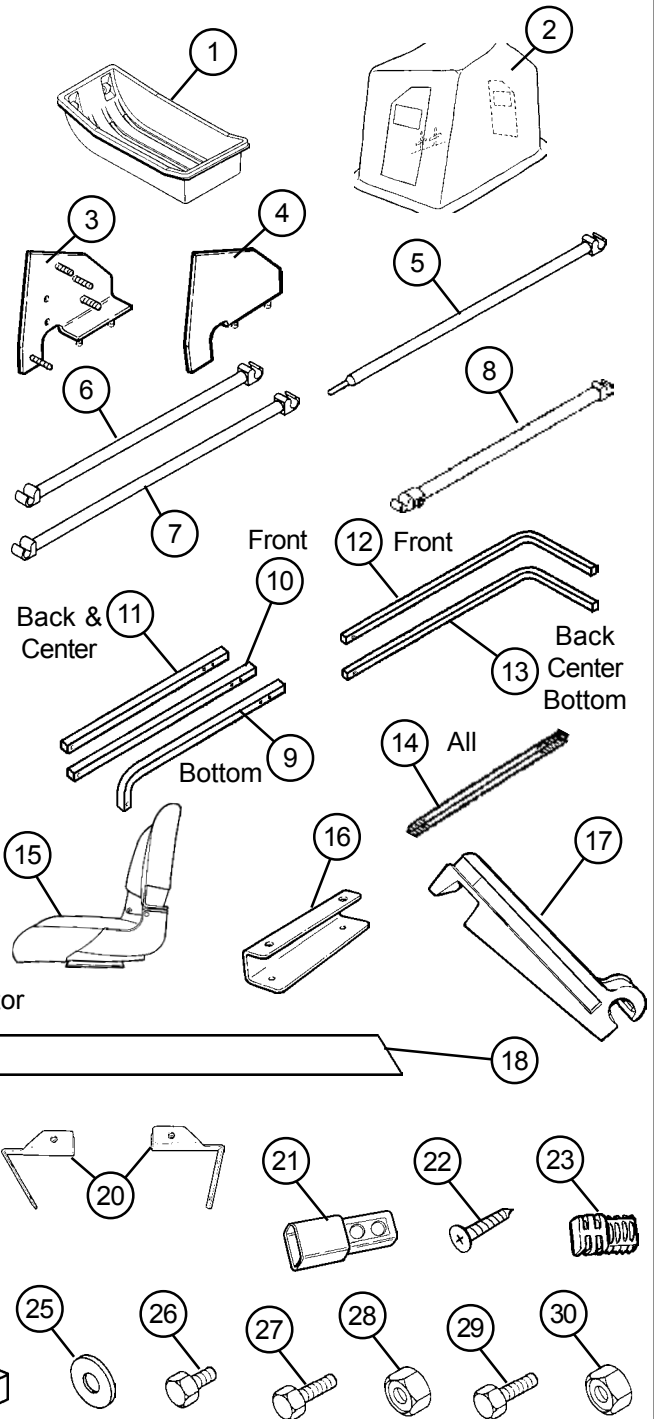

Tools Required:

7/16" Box End Wrench	3/8 Bit
7/16" Socket and Ratchet	5/16 Bit
Drill/Driver	Complete Pkg Only
Phillips Bit	1/2" Wrench
3/32 Drill Bit (optional)	1/2" Socket

1. Layout all parts and position sled as shown in Diagram 1. Measure 17" from the front/left corner of the sled and 7/8" down and mark the location for the top hole needed for the seat rail bracket (Item 20). Measure 17-1/2" from the rear/left corner of the sled and 7/8" down and mark the location for the top hole needed on the other side. Check bracket placement to be sure brackets are either flush with top edge of sled or below the edge. Drill the two 5/16" holes through the sled. Ref. Diagram 1.

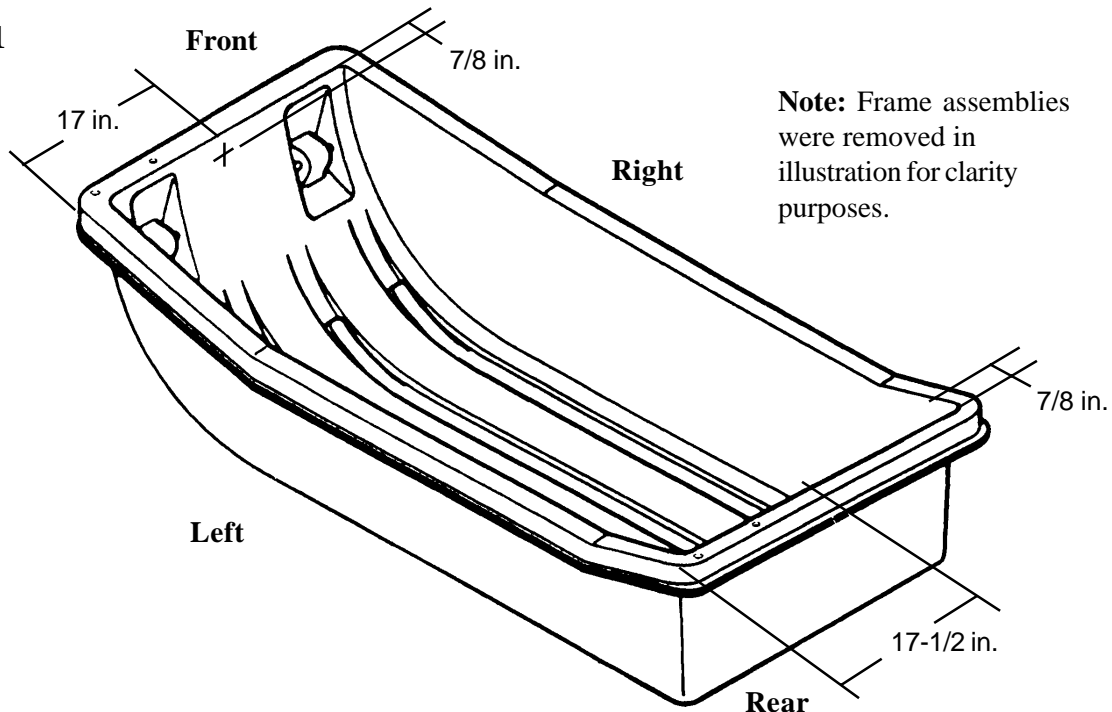
Diagram 1

2. Place the seat rail bracket (Item 20) on the first hole and mark second hole location. Note: Bracket for front of sled has a different bend than the rear of sled. Drill the remaining two 5/16" holes through the sled. Do not attach the brackets to the sled at this point. Ref. Diagram 2.

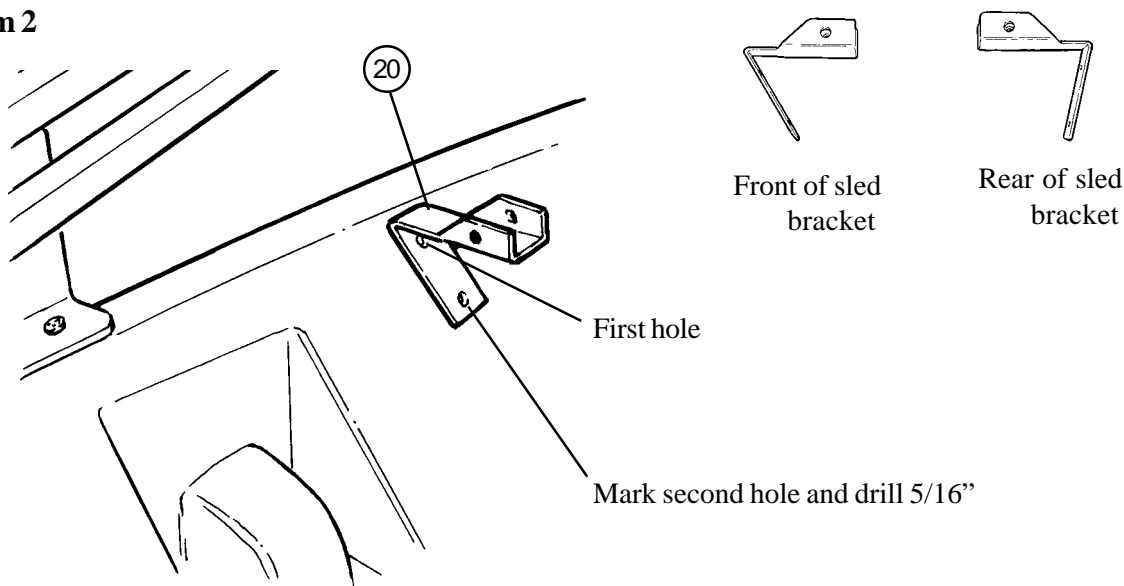
Diagram 2

3. Attach seat rail (Item 18) to seat rail bracket (Item 20) and secure with bolt (Item 29) and nut (Item 30), both ends. Attach seat rail cap (Item 19) to seat rail (Item 18) and secure with self tapping screws (Item 22). Attach seat rail brackets (Item 20) to the sled, both ends, and secure with bolt (Item 27) and nut (Item 28).
Ref. Diagram 3.

Diagram 3

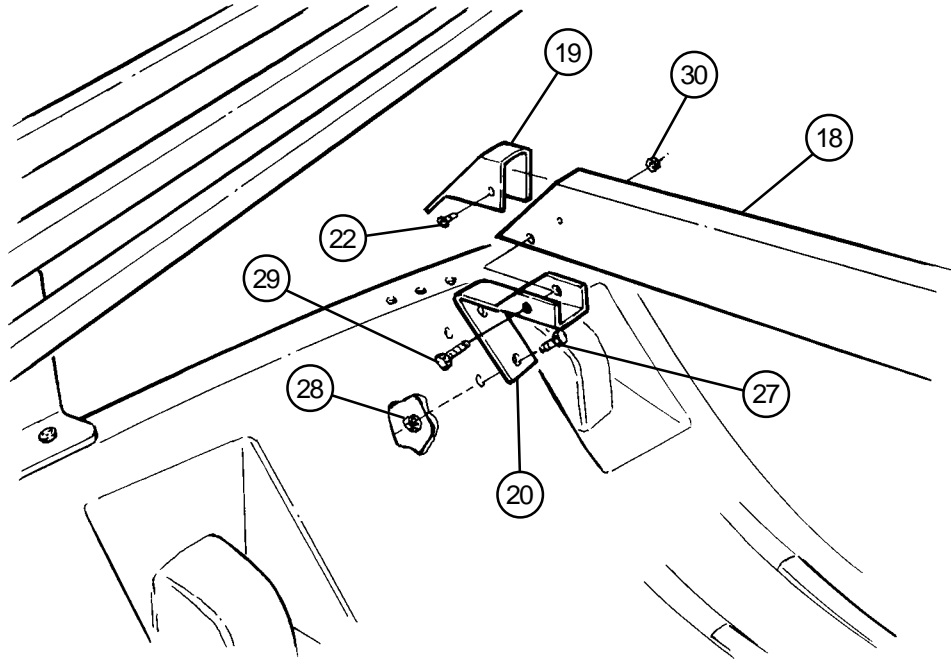

4. Fasten the seat brackets (Item 16) to the seat (Item 15) with four bolts (Item 26) and nuts (Item 28).
Ref. Diagram 4.

Diagram 4

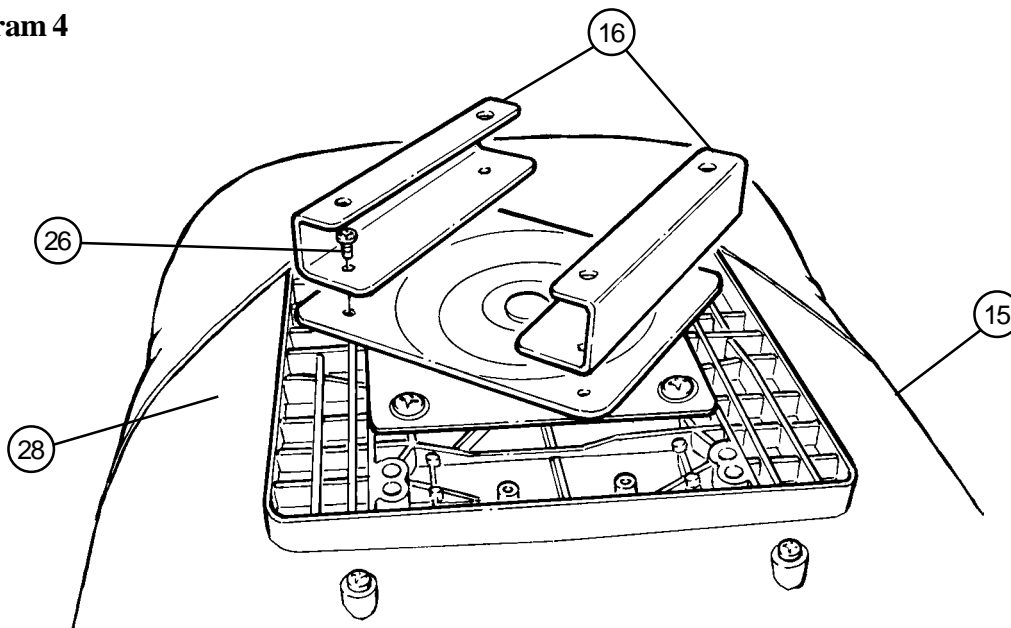

5. Position seat base (Item 17) as shown and lock onto the seat rail (Item 18). Lower the seat base onto the sled. Ref. Diagram 5.

Diagram 5

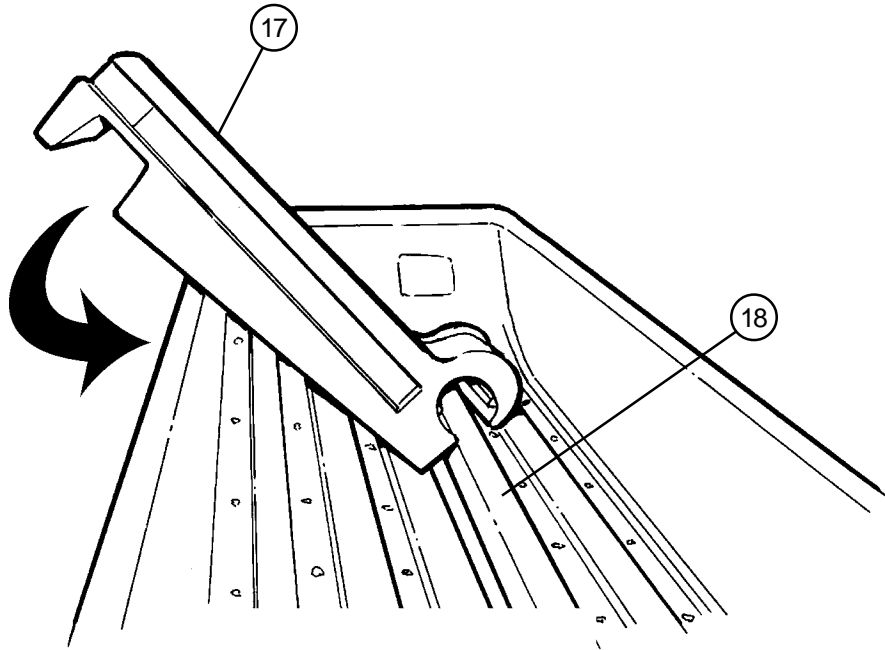

6. Slide the seat assembly (assembled in step 4) onto the seat base (Item 17). Check the fit on the plastic seat base (Item 17) and adjust the metal brackets as necessary to achieve the desired fit. Ref. Diagram 4 and 6.

Diagram 6

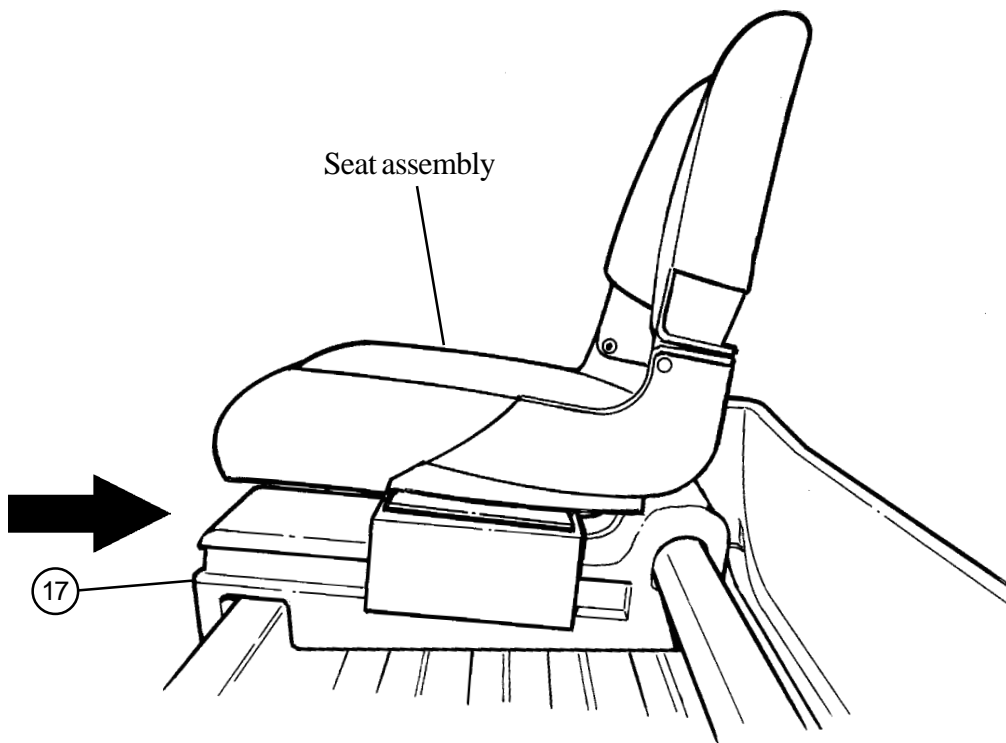

7. Position sled (Item 1) as shown in Diagram 7, with curved front to your left. Using front drilling pattern (on back page) mark two holes for the front frame bracket with a sharp object. Using rear drilling pattern (on back page), repeat this step for the rear frame bracket.
8. Drill the 4 marked holes using a 5/16 bit.
9. Drill the 3/8 in. hole in center of lip approximately 16 inches from bend in sled. The back wind support bar (Item 5) is to be propped here.

Diagram 7

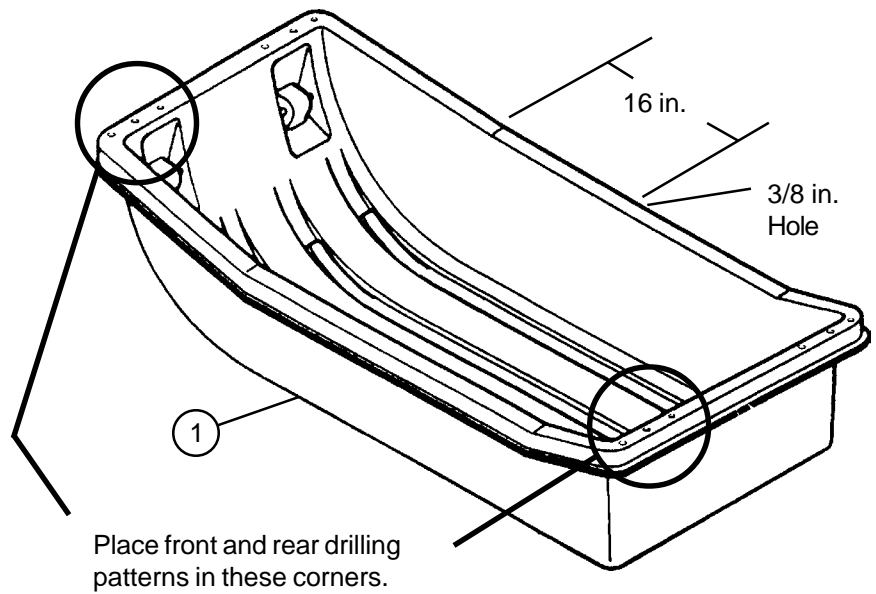

10. Bolt frame brackets (Item 3 and Item 4) to sled using holes predrilled in Step 8. Use appropriate fasteners shown in Diagram 8.

Diagram 8

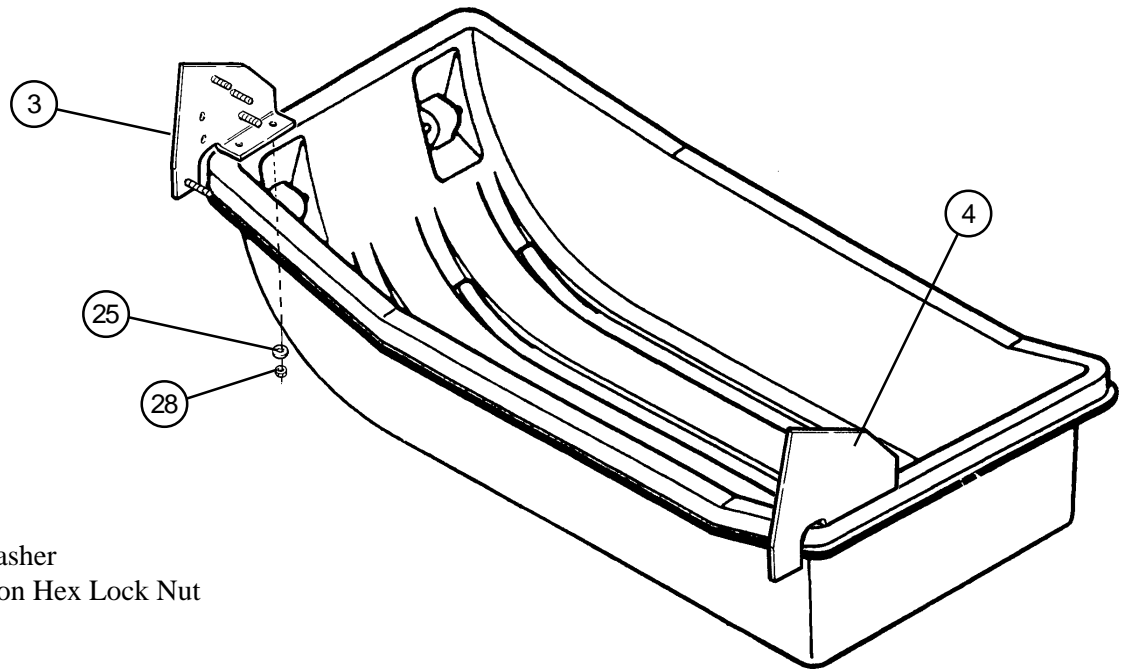

Item 25 - 5/16 Washer
 Item 28 - 1/4 Nylon Hex Lock Nut

11. Assemble **Back and Center Main Frame Bars**: Insert the outer main frame bar (Item 13) into the middle main frame bar (Item 14). Fasten with self-tapping screw and plastic protector (Item 22). Slide the sleeve (Item 21) over the main frame extension bar (Item 11). (**Line up holes with button lock, press lock in as you slide over the bar**). Insert the black plug (Item 23) into the main frame extension bar (Item 11). Insert outer main frame bar (Item 13) into sleeve (Item 21). Cover end of main frame extension bar (Item 11) with black end cap (Item 24). Ref. Diagram 9.

Diagram 9

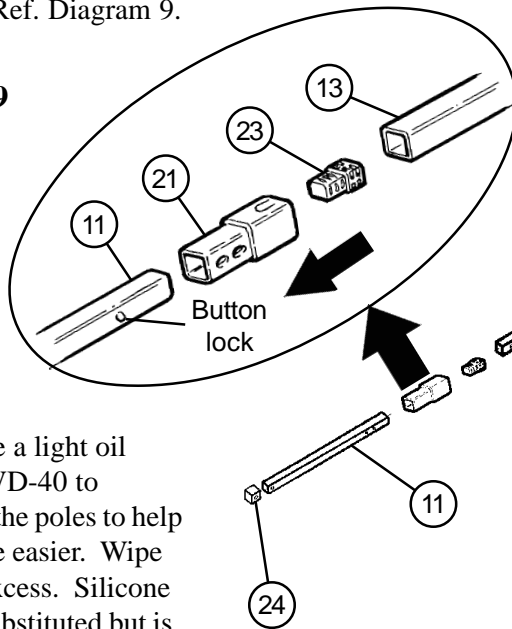

Note: Use a light oil such as WD-40 to lubricate the poles to help them slide easier. Wipe off any excess. Silicone may be substituted but is not as effective.

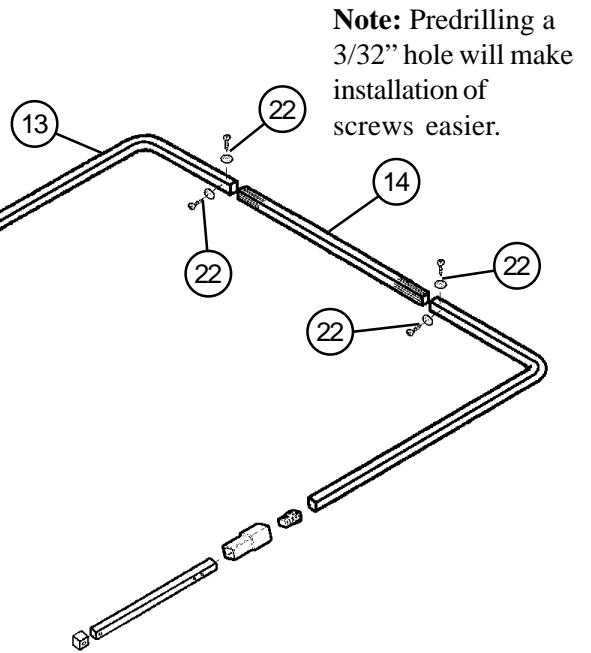

Note: Predrilling a 3/32" hole will make installation of screws easier.

12. Attach **Back and Center** main frame assemblies (Assembled in Step 11) onto frame brackets (Item 3 and 4). Secure with 1/4 nylon hex lock nut (Item 28). Ref. Diagram 10.

Diagram 10

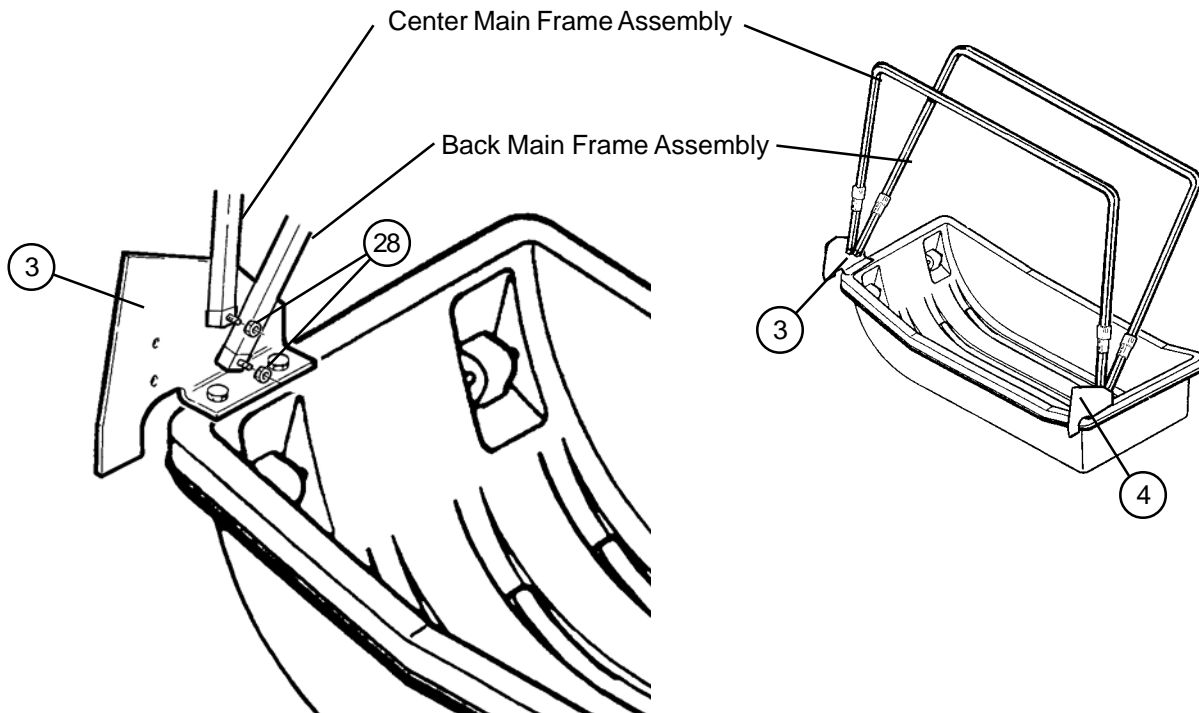

13. Assemble **Front Main Frame Bar**: Insert the outer main frame bar (Item 12) into the middle main frame bar (Item 14). Fasten with self-tapping screw and plastic protector (Item 22). Slide the sleeve (Item 21) over the main frame extension bar (Item 10). (**Line up holes with button lock, press lock in as you slide over the bar**). Insert the black plug (Item 23) into the main frame extension bar (Item 10). Insert outer main frame bar (Item 12) into sleeve (Item 21). Cover end of main frame extension bar (Item 10) with black end cap (Item 24). Ref. Diagram 11.

Diagram 11

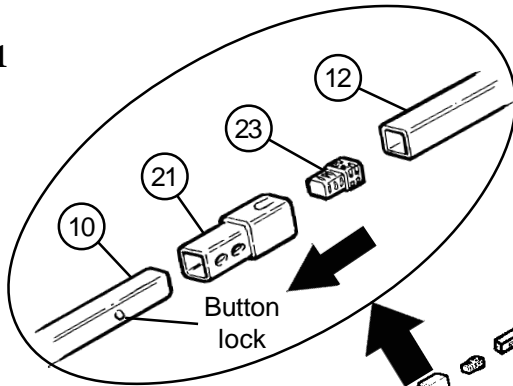

Note: Use a light oil such as WD-40 to lubricate the poles to help them slide easier. Wipe off any excess. Silicone may be substituted but is not as effective.

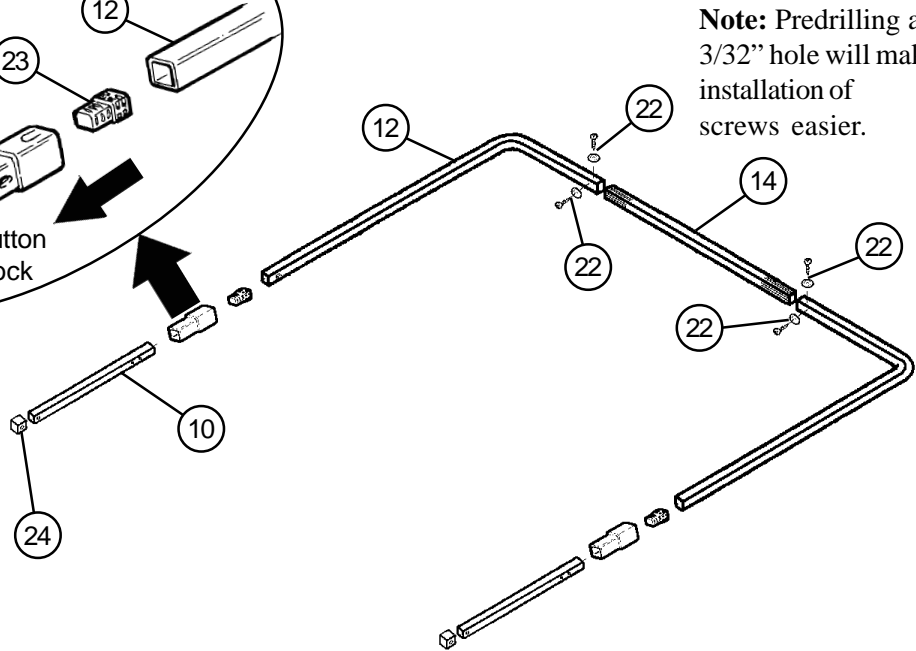

Note: Predrilling a 3/32" hole will make installation of screws easier.

14. Attach **Front** main frame assembly (Assembled in Step 13) onto frame brackets (Item 3 and 4). Secure with 1/4 nylon hex lock nut (Item 28). Ref. Diagram 12

Diagram 12

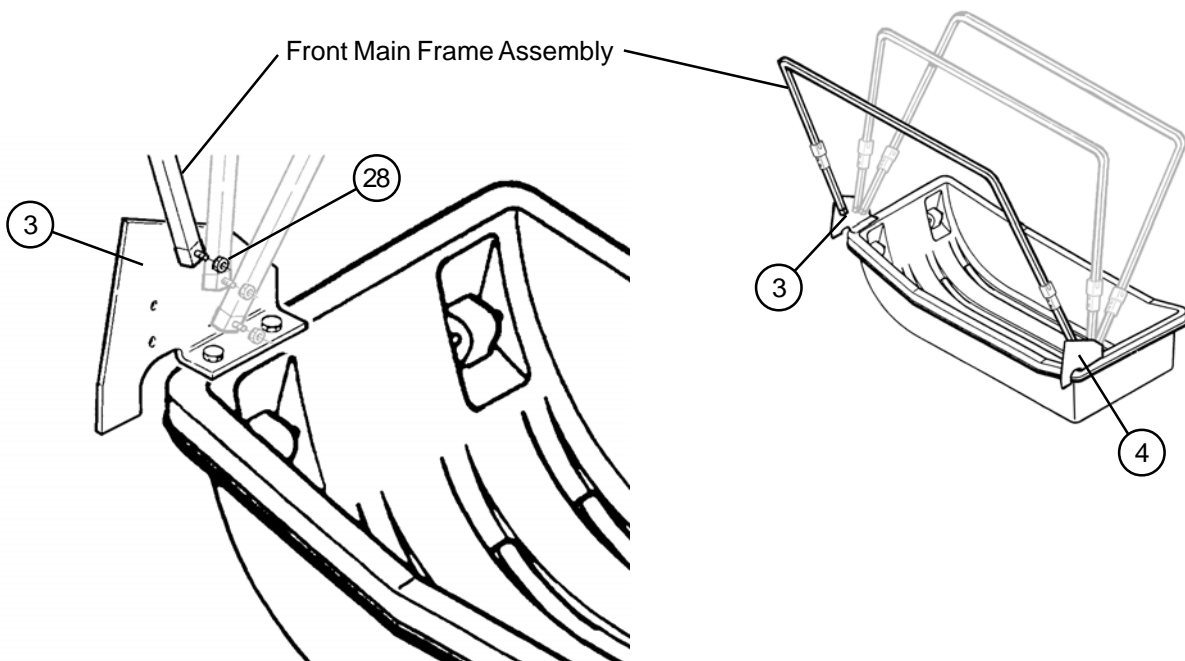

15. Assemble **Bottom Main Frame Bar**: Insert the outer main frame bar (Item 13) into the middle main frame bar (Item 14). Fasten with self-tapping screw and plastic protector (Item 22). Slide the sleeve (Item 21) over the main frame extension bar (Item 9). (Line up holes with button lock, press lock in as you slide over the bar). Insert the black plug (Item 23) into the main frame extension bar (Item 9). Insert outer main frame bar (Item 13) into sleeve (Item 21). Cover end of main frame extension bar (Item 9) with black end cap (Item 24). Ref. Diagram 13.

Diagram 13

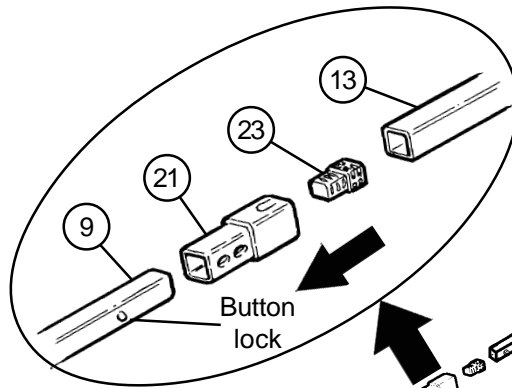

Note: Predrilling a 3/32" hole will make installation of screws easier.

Note: Use a light oil such as WD-40 to lubricate the poles to help them slide easier. Wipe off any excess. Silicone may be substituted but is not as effective.

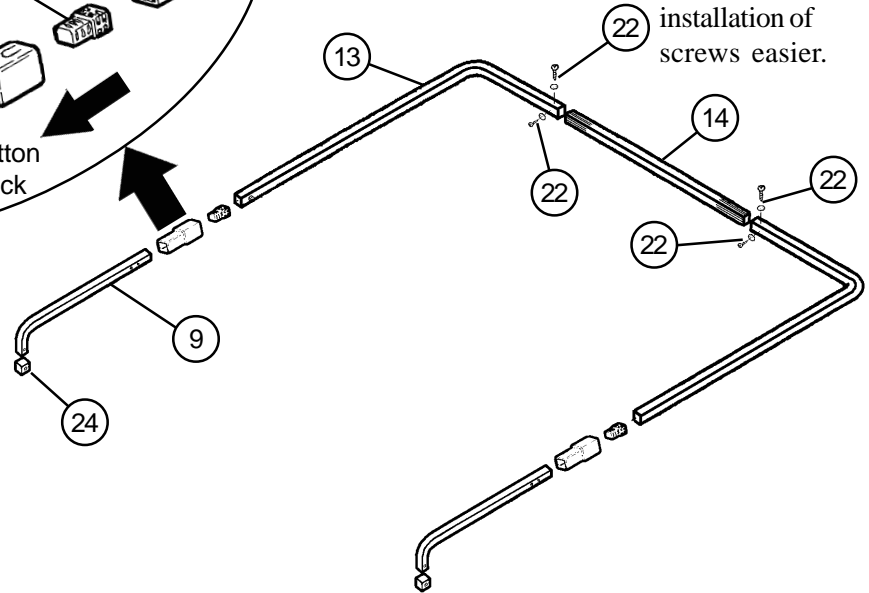

16. Attach **Bottom** main frame assembly (Assembled in Step 15) onto frame brackets (Item 3 and 4). Secure with 1/4 nylon hex lock nut (Item 28). Ref. Diagram 14.

Diagram 14

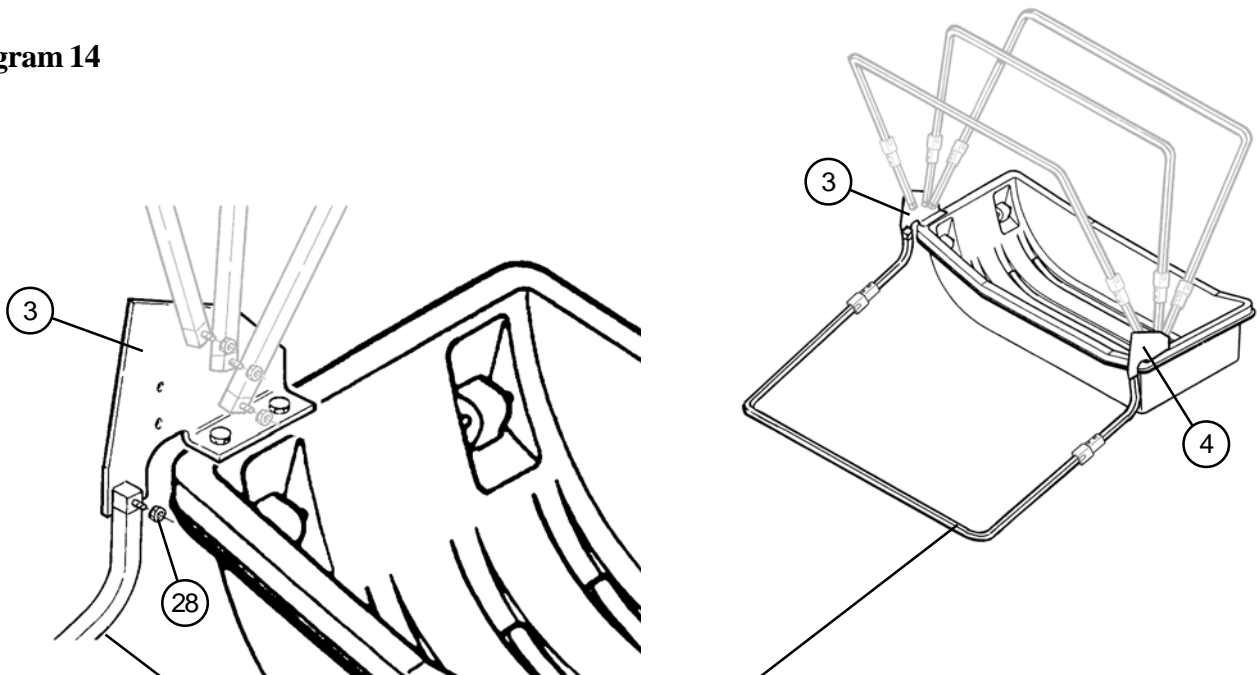

Bottom Main Frame Assembly

17. Set up main frame bars by grasping with both hands and pushing upward until button clicks into place. Start with bottom main frame bar and continue to the back main frame bar pushing lengthened bars into appropriate position Ref. Diagram 15.

Diagram 15

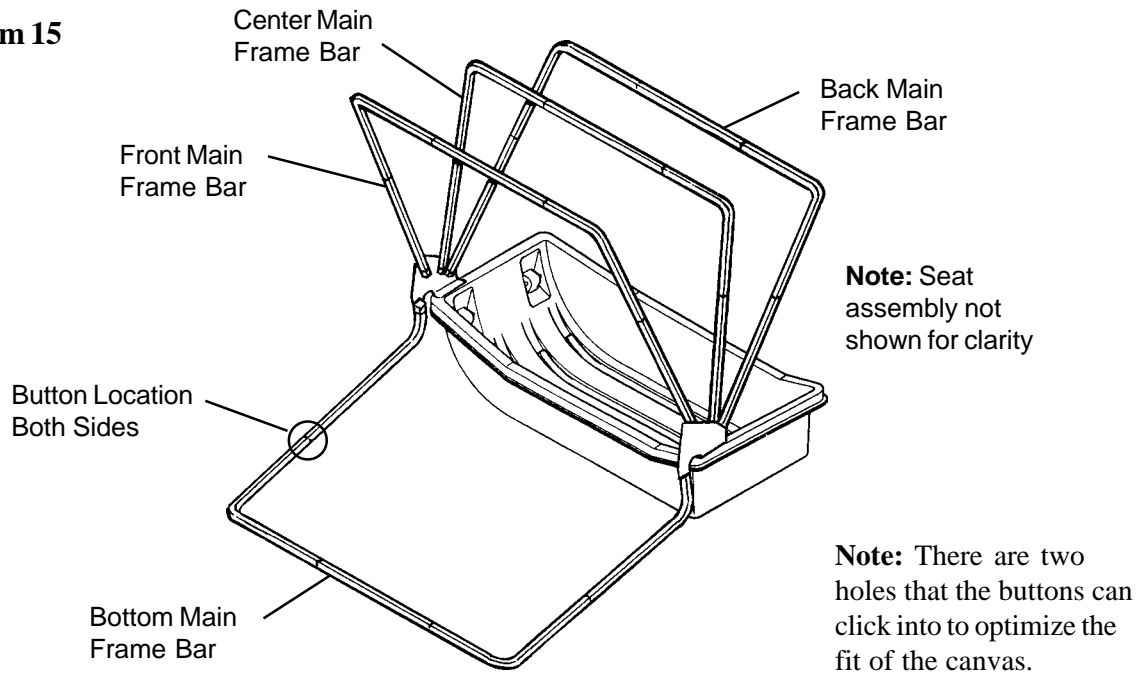

18. Install wind support bars starting in back (Item 5), up through center (Item 6), then between the front and center main frame bars (Item 7) and finally with adjustable wind support bar (Item 8) in front. Ref Diagram 16.

Diagram 16

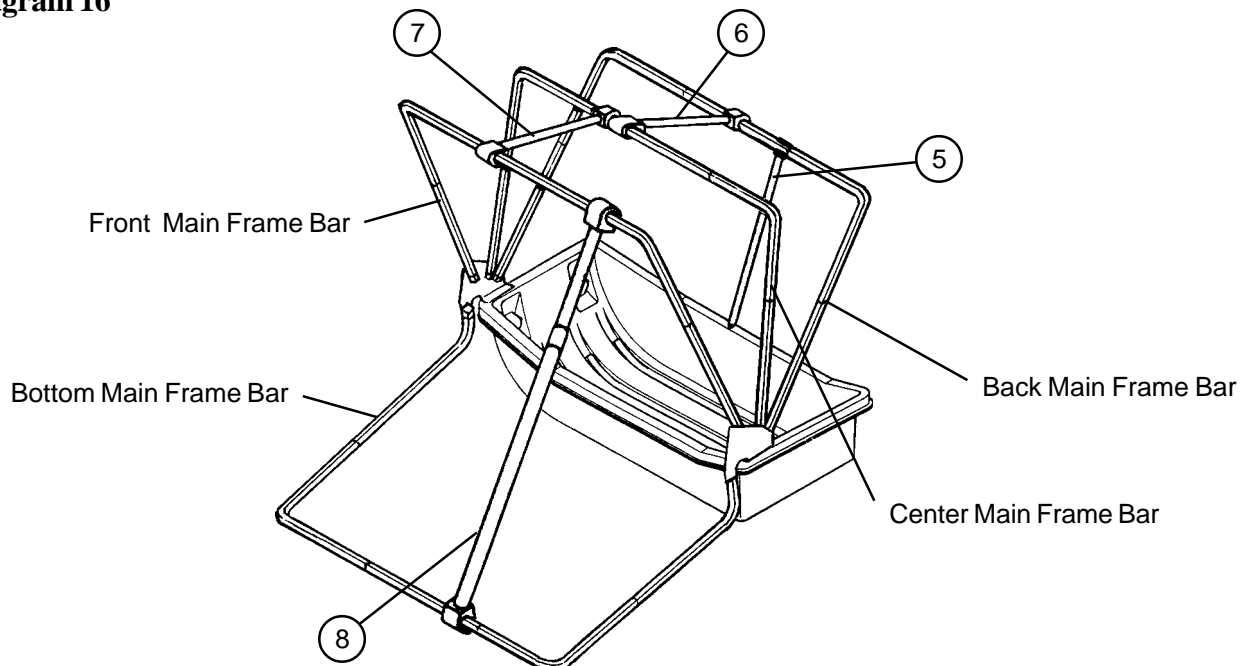

19. Slide the tent over the main frame bar assembly, then fasten the velcro straps on the inside of the tent to each main frame bar. Ref. Diagram 17.

Diagram 17

Note: Collapsing the center and front main frame poles part way down will make installation easier.

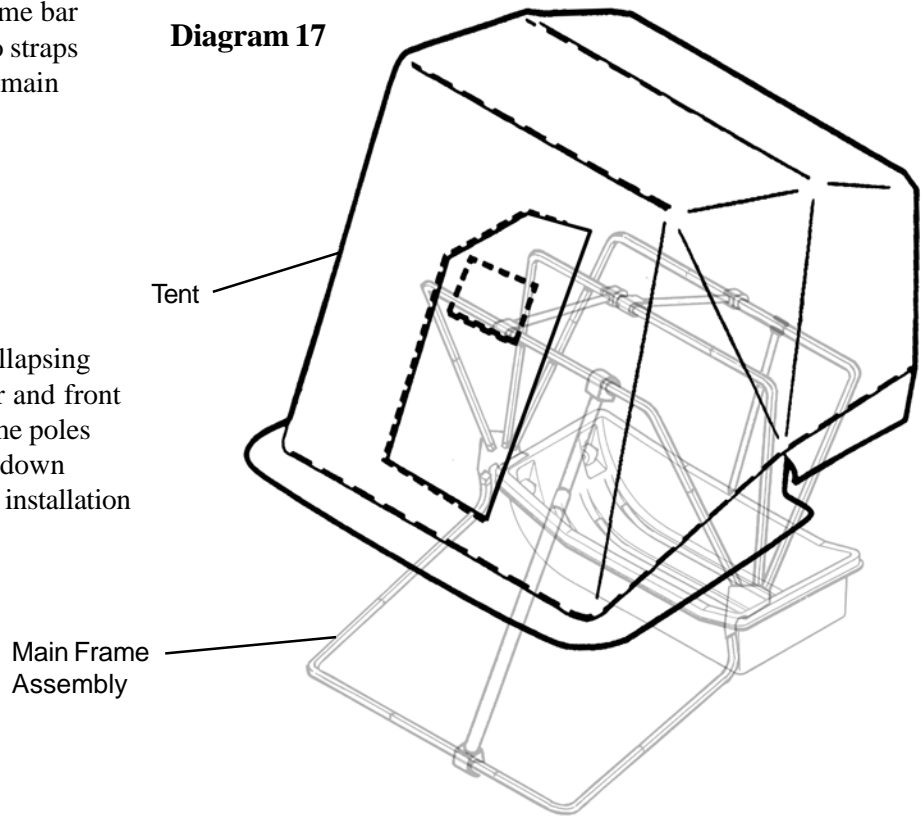

20. The canvas tent (Item 2) has a plastic trim seal sewn into the edge, snap the plastic trim seal to the edge of the sled (Item 1). Start at the front left corner and work your way around across the back and up the opposite side. Secure with extra self-tapping screws if needed. See detail A. Ref. Diagram 18.

Diagram 18

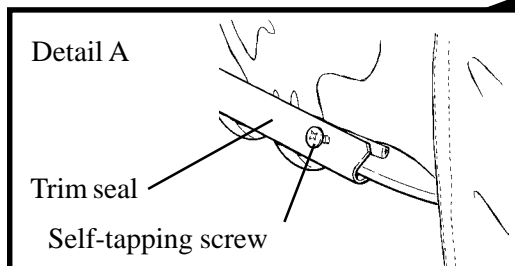
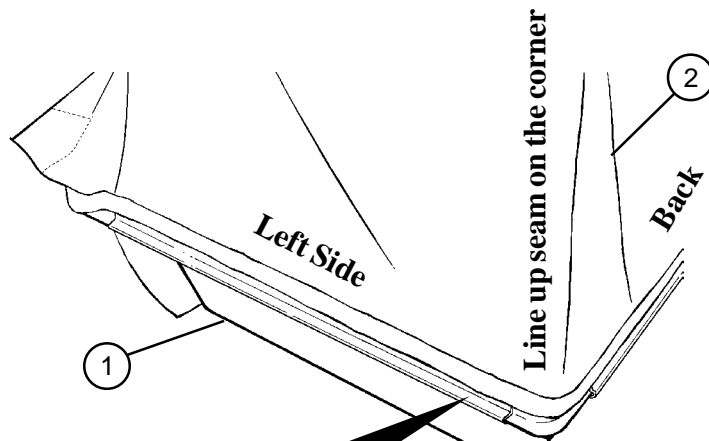
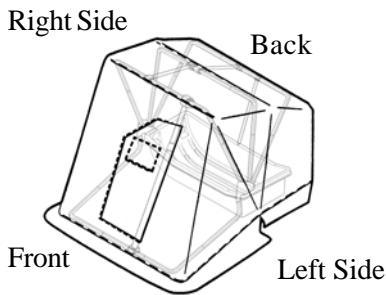

21. On the front of the fishhouse, start in the corners and work inward, snap the plastic trim seal on the canvas tent (Item 2) to the **top** edge of the sled (Item 1) Ref. Diagram 19.

Diagram 19

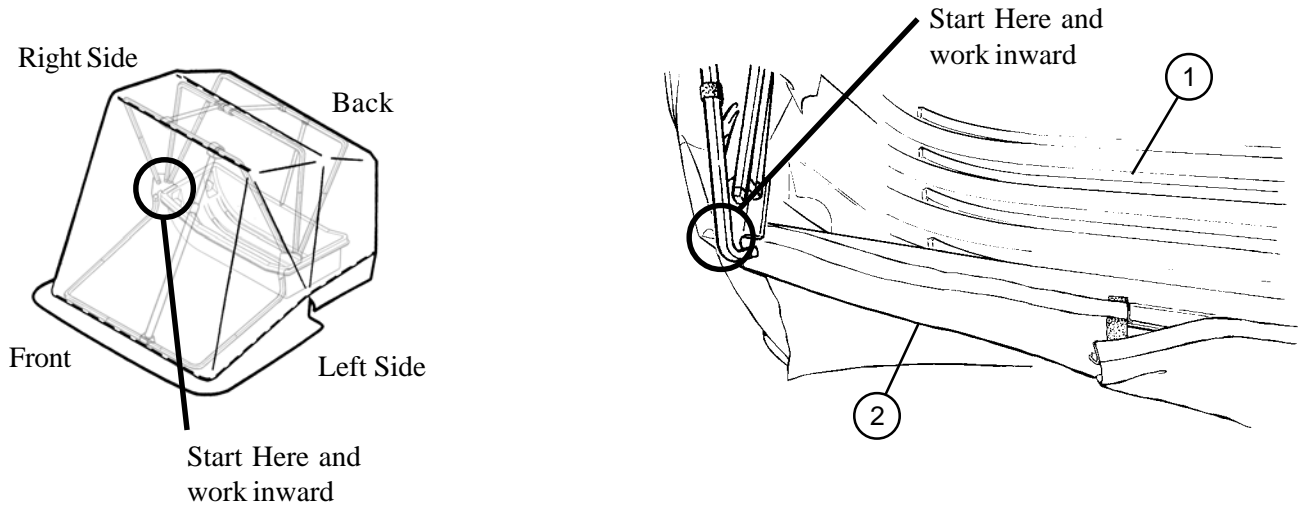

22. The tent (Item 2) will meet in the middle and should be free to open and close so it can be removed.

To Collapse Tent and Transport:

1. Remove support bars and store inside the sled.
2. Retract main frame bars by pressing in button while sliding the bar farther into the tube.
3. Fold the tent in towards the sled so all the bars are laying on top of the sled.
4. Tuck in excess tent material.
5. Ready for transport.
6. Reverse to set up the fishhouse again.

Fold tent inward towards sled.

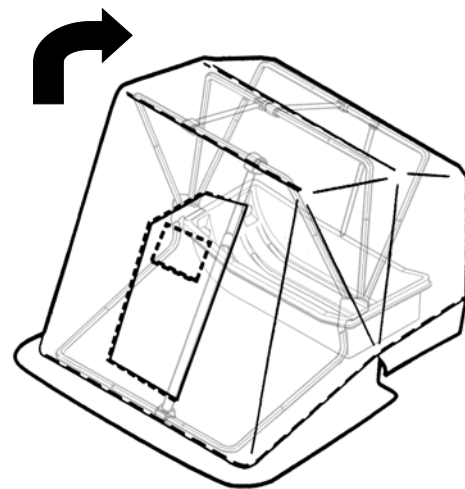

General Note: Be careful with tent windows in cold weather, as creasing or crushing them will cause breakage.



Caution: Use adequate ventilation. Portable heaters use up oxygen and emit carbon monoxide. Use reflectors and identifying lights after dark or during limited visibility.

REAR OF SLED



Match this line to edge of sled.

**HOLE DRILLING PATTERN FOR
OTTER PRO ICE LODGE USING
MAGNUM OTTER II & PRO SLED
ONLY**

**NOTE: Back of sled is slightly wider than front
of sled so hole placement is not the same.**

Drill two bracket holes using 5/16" drill bit.

Match this line to edge of sled.



FRONT OF SLED

OUTSIDE EDGE OF SLED